



X-MAN DESIGN

# TORNADO AI SMART CUBE USER MANUAL



Scan QR code to  
watch the video

Thank you for choosing our Smart Cube.  
Welcome to the intelligent speedcubing era!

## 1. Important Notes Before Use

\*Please read carefully before use and keep this manual safe.

- Before first use, charge the cube for at least 10 minutes to ensure sufficient battery power.
- This product has built-in sensors to track cube dynamics. The positions of the cube's faces are fixed. Do not swap the positions of the center caps.
- After waking up, if the white face's red light stays lit for 4 seconds OR the battery level is below 10%, it indicates low battery. Charge promptly to ensure performance.
- During charging, always place the cube with the "White face up, Green face forward" orientation into the charging box or base, as shown in the diagram:

White center cap facing up, the four side center caps matching the color markings on the sides of the charging base/box.

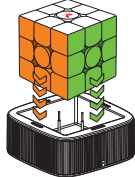

## 2. Product Configuration

Charging Box Version	Charging Base Version

## 3. Basic Specifications

Model	X-Man Design Tornado AI Smart Cube
Size	55.5x55.5x55.5mm
Weight	Approx. 75g
Battery Type	3.7V Lithium Battery
Charging Time	Approx. 1h
Battery Life	Fully Charged: Usage Time Approx. 25h Fully Charged: Standby Time Approx. 60 days Low Battery: Charge for 10 mins, play for 5 hours*
USB Power Adapter Requirement	<= 5V2A
Connection	Wireless
Device Requirements	iOS 12.0 or later, Android 10.0 or later, devices with Bluetooth 4.2 or later.

1 One-Think Lab data. Actual battery life is closely related to network conditions and usage patterns. Enabling the gyroscope function will reduce battery life.

2 One-Think Lab data. Actual charging speed is closely related to the remaining battery capacity. Results may vary.

## 4. Charging Methods

\*This product comes with either a charging base or charging box depending on the purchased version.

### 1. Using the Charging Base:

- Power the charging base using a USB Type-C power cable.
- Place the cube into the charging base with the "White face up, Green face forward" orientation.

Tips: · The four side center caps must match the color markings on the sides of the charging base.  
· The base's white indicator light will turn on, indicating charging is in progress.  
· The light will turn off when charging is complete or if no cube is placed in the base.

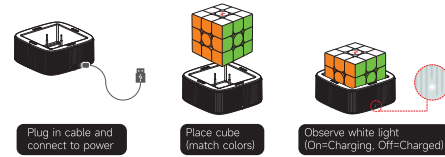

### 2. Using the Charging Box:

- Place the cube into the charging box with the "White face up, Green face forward" orientation (side center caps match box color markings).

· The box's "CUBE" white indicator light will turn on, indicating the cube is charging.  
· The box's "BOX" light indicates the remaining battery level of the box itself. It turns off automatically after 10 seconds. Press the box button once to check the cube's charging status and the box's remaining battery.  
· Power the charging box using a USB Type-C power cable. The "BOX" light will blink while the box is charging.

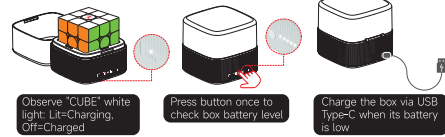

### Charging Box Basic Specifications

Model	X-Man Design Tornado AI Smart Cube Charging Box
Size	78x78x73mm
Weight	Approx. 94g
Battery Type	3.7V Lithium Battery
Charging Time	Box from 0-100%: Approx. 1.5h
Battery Capacity	1000mAh (Can charge Tornado AI approx. 6-9 times)
USB Power Adapter Requirement	<= 5V2A

1 One-Think Lab data. Actual number of cycles depends on the cube's remaining charge and box storage time. Results may vary.

## 5. APP Download



①Scan QR code to download APP.

②For iPhone users, you can search for "Smart Player Pro" in the APP Store to download and install the APP. For Android users, you can search for "Smart Player Pro" in Google Play to download and install the APP.

\*The Apple logo and App Store are trademarks registered by Apple Inc. in the United States and other countries and regions.  
\*The Google Play logo is a registered trademark of Google Inc.

## 6. Connecting the Cube

\*Requires APP version 2.4.1 or later

- Log in to your Smart Player Pro account.  
New users: No registration needed. Log in directly using your mobile number (+86) or email to receive a verification code.

- Wake up the Cube: Rotate any face of the cube. The white face's red light will blink for 4 seconds to indicate it's awake.

\*Note: After waking, rotating again won't light the indicator. The cube will auto-sleep after 60 seconds of inactivity. If it doesn't wake, check battery level or try 20 consecutive moves on the white face to see if the light activates.

- In the APP, tap the "Connect the Cube" button and follow the prompts.  
\*Ensure your phone's Bluetooth, Location Services, and permissions granted to the APP.  
\*If the cube isn't found: Try doing 20 consecutive moves on the white face to reset the cube's Bluetooth.

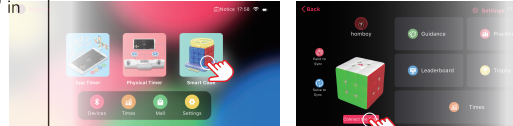

Step ①

Step ②

## 7. Cube Adjustment

### 1. Elasticity & Axis Distance Adjustment

Tornado AI has 5 levels of elasticity and 5 levels of axis distance adjustment. Open the center cap and turn the adjustment mechanism directly with your finger.

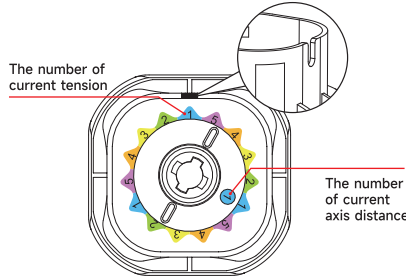

### ● Elasticity

Turn the mechanism clockwise. Check the tension level (1-5) via the number aligned with the notch on the cap edge. Higher number = Stronger tension, Default setting: Level 3.

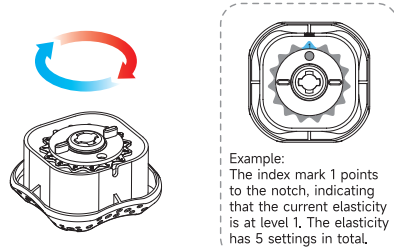

### ● Axis Distance

Turn the mechanism counter-clockwise. Check the axis level via the number visible in the hole. The larger the number, the tighter(smaller)the axis distance,The axis distance has a default setting of 3.

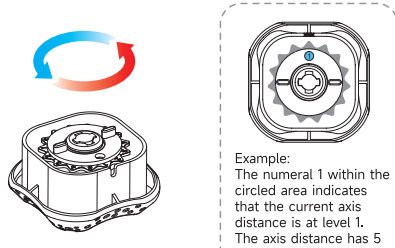

### 2. Magnet Strength Adjustment

Tornado AI has 5 levels of magnetic strength adjustment. The magnetic system is located on the corner piece contact surfaces. Featuring a three-face linkage design, adjust using the slotted Head Adjusting Tool. Only adjust the 8 corner pieces (8 times) to set the magnetism for the entire cube.

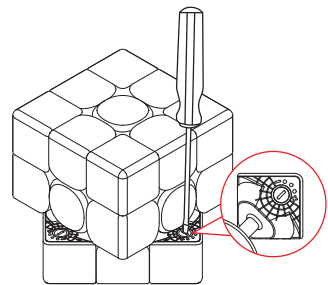

The magnetic force increases from left to right.

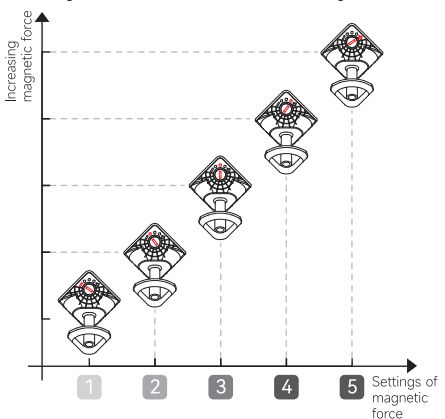

## 8. Precautions

- Ensure your phone's Bluetooth and Location Services are enabled and permissions granted to the APP.
- After connecting to the APP, if there is no operation for 10 minutes, the cube will automatically disconnect Bluetooth and enter sleep mode.
- If the cube is already bound to another account, you must reset the cube's Bluetooth before a new account can search and connect to it.  
Reset Method: Make 5 full consecutive rotations (20 moves) on the white face. The white face indicator will blink for 4 seconds then stay lit for 4 seconds, indicating a successful reset.
- If the white face's red light stays lit upon waking, it indicates low battery. Charge the cube promptly.
- Do not subject this product to impact, water, or environments above 60°C. Operating temperature: -20°C to 50°C.
- This product contains small parts. Not for children under 3 years old.
- Use the product strictly according to the manual to avoid device damage or personal injury due to improper operation.

## 9. Troubleshooting

### 1. APP cannot find the cube?

- Confirm phone Bluetooth and Location Services are ON and permissions granted to the APP.
- If the cube is connected or bound to another device, reset the cube's Bluetooth first.  
\*Reset Method: Make 5 full consecutive rotations (20 moves) on the white face. The white face indicator will blink for 4 seconds then stay lit for 4 seconds, indicating a successful reset.
- Confirm the cube has sufficient battery.
- Confirm the cube is awake. An awakened cube will auto-sleep after 60 seconds if not connected to the APP.

### 2. Cube state out of sync with APP display?

- Confirm all center caps are correctly positioned.
- Use the APP's reset function (Solve Reset / Color Fill Reset) to reset the cube state.
- Low battery can cause auto-sleep and sync failure. Charge the cube promptly.

- For more issues, visit [one-think.com](http://one-think.com) for technical support or contact us via [service@one-think.com](mailto:service@one-think.com).